

Build-to-Suit, Sale or Lease

Middlesex Logistics Center

Edison, NJ

COUNT ON OUR COMMITMENT

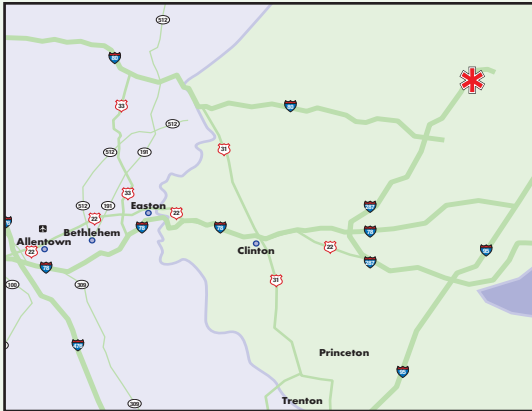

Just off NJ Turnpike Exit 10!

42 acres

- Fully approved
- 571,000 sq. ft. industrial building
- Pre-cast panel construction
- 36' clear ceiling height
- 50' x 60' stage bays
- 108 9' x 10' dock doors (cross load)
- Four 12' x 14' drive-ins
- 140' Truck Courts & 60' concrete aprons
- Parking for 190 cars and 149 trailers
- Highlights include a flexible, efficient design, state-of-the-art building features, an excellent labor pool, competitive economics, and experienced ownership.

Our Leadership Pledge

At J.G. Petrucci Co., Inc., we:

- * Provide quality facilities that reflect the character of our clients and stand the test of time
- * Relentlessly pursue total client satisfaction
- * Respond to the needs of the community
- * Create value and opportunity for clients, service providers, tradesmen and employees
- * Set a standard of conduct that reinforces traditional notions of service, accountability and integrity

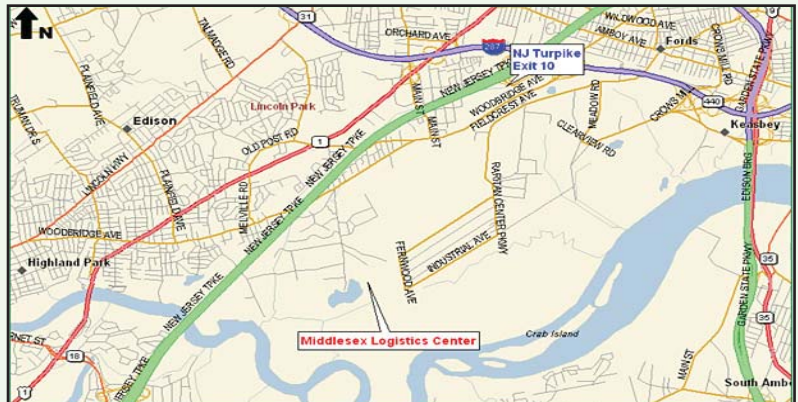

For information or to schedule a tour, contact:

Dan Lacz
J.G. Petrucci Company, Inc.
(908) 730-6909
dlaczi@jgpetrucci.com

Build-to-Suit, Sale or Lease

Middlesex Logistics Center

Edison, NJ

COUNT ON OUR COMMITMENT

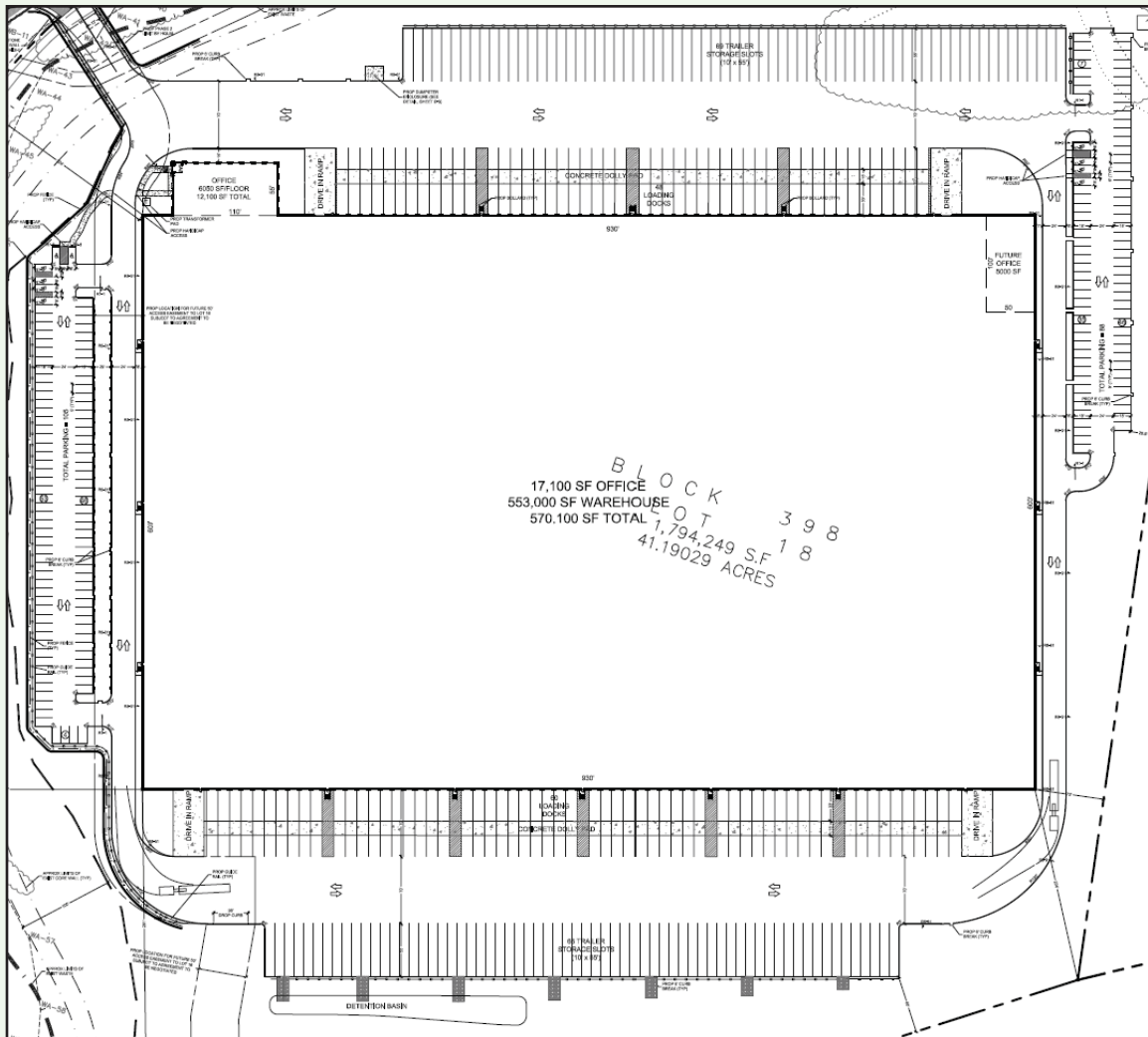

Our Leadership Pledge

At J.G. Petrucci Co., Inc., we:

- * Provide quality facilities that reflect the character of our clients and stand the test of time
- * Relentlessly pursue total client satisfaction
- * Respond to the needs of the community
- * Create value and opportunity for clients, service providers, tradesmen and employees
- * Set a standard of conduct that reinforces traditional notions of service, accountability and integrity



For information or to schedule a tour, contact:

Dan Lacz
J.G. Petrucci Company, Inc.
(908) 730-6909
dlacz@jgpetrucci.com