



Building Highlights

156,000 sq. ft.

32' clear ceiling heights

ESFR sprinkler System

28 loading docks
(135 ft. deep truck courts)

118 parking spaces

Class 'A' Industrial Manufacturing Site Available

PAD READY!

- High visibility
- All utilities available
- Zoned Industrial Redevelopment
- LERTA, KIZ, and FTZ Tax Incentives
- Public transportation Available!
- Excellent access to I-78 and Routes 412, 22, and 33
- Minutes from New Jersey!

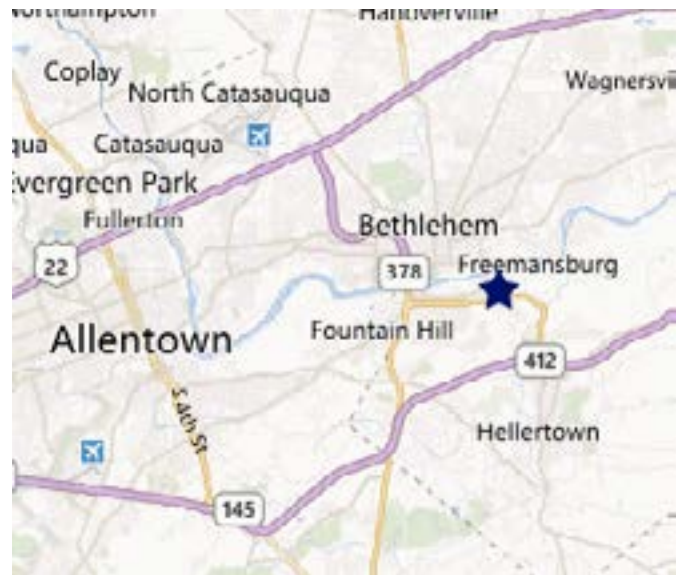

For more information or to schedule a tour contact:

Martin K. Till

mtill@jgpetrucci.com

(610)332-0555



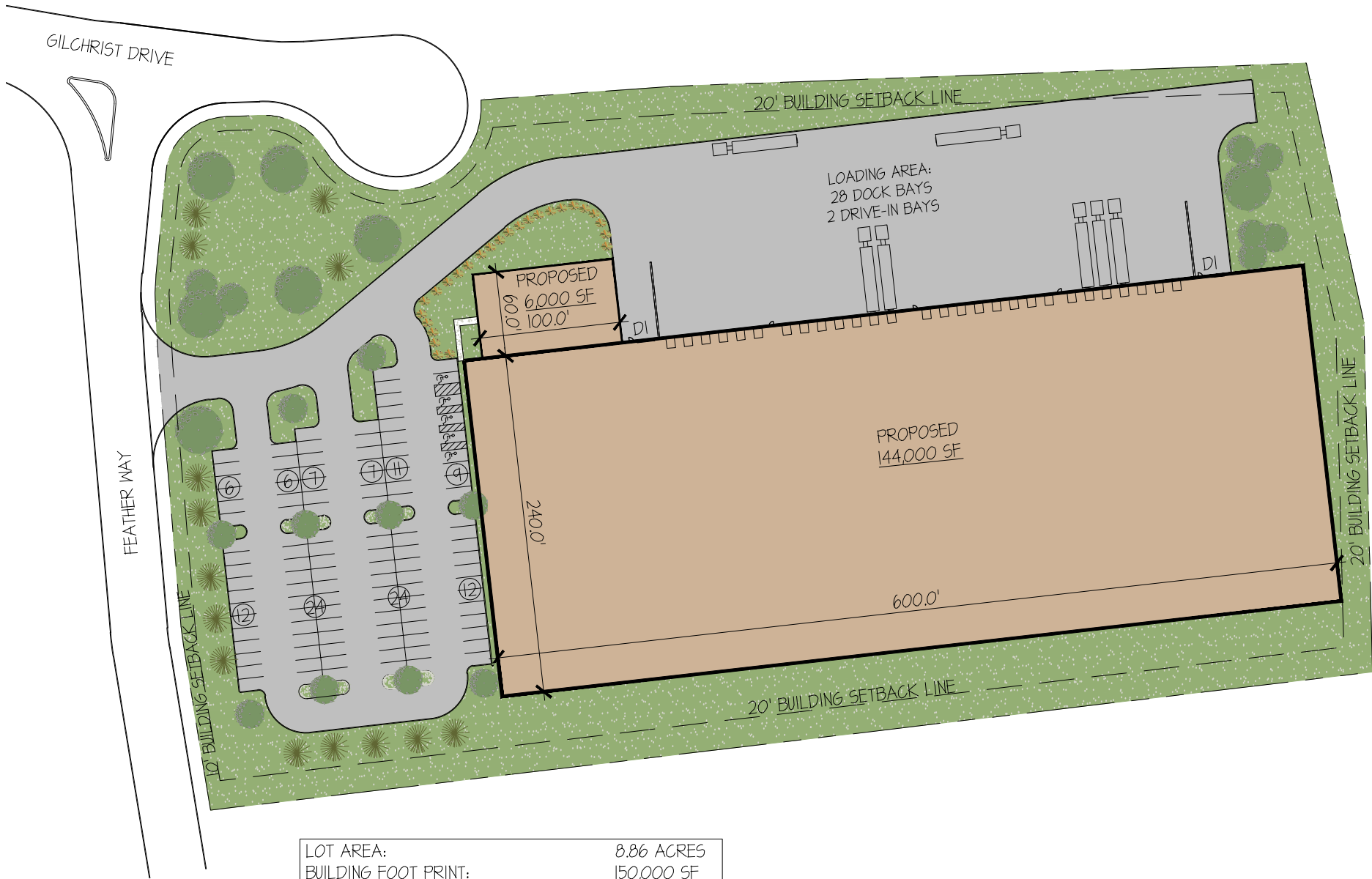

LOT AREA:	8.86 ACRES
BUILDING FOOT PRINT:	150,000 SF
TOTAL # OF PARKING SPACES:	118 SPACES